

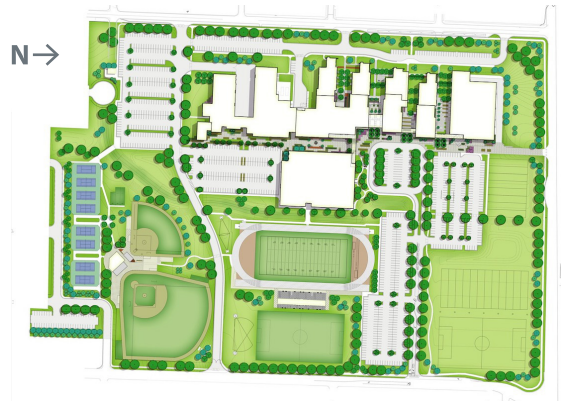

JOPLIN HIGH SCHOOL **FRANKLIN TECHNOLOGY CENTER**

Architect:	Corner Greer & Associates, Inc. / DLR Group
Grades served:	9-12
Capacity:	2,500+ students
Site area:	66 acres (total site including athletic complex)
Building area:	487,937 sq. ft.
Estimated project cost:	\$124.6 million
Opening date:	Sept. 2, 2014



Project Summary:

The new Joplin High School and Franklin Technology Center combines a comprehensive high school and career education center into one building where the focus is on each individual student’s education and career interests. The facility is designed to support 21st century learning, which focuses on collaborative work, experienced-based study, inquiry-based problem solving, real-world application, and student-led study. The school features flexible spaces for students and staff, several indoor and outdoor areas that encourage social interaction, and amenities that support increased parent and community engagement.

Students attending the school can choose from an expanded selection of classes clustered within five career paths. These include numerous college dual credit and Advanced Placement courses and personalized learning experiences. Within these classes, students can participate in real-world work environments such as the student-run spirit store, coffee shop, restaurant, green house, TV station, and more.

Features:

- Designed with a college, career, and technology focus
- Flexible and collaborative learning spaces
- Windows and glass throughout the building emphasize “learning on display” and allow students to experience other career paths
- 4 student/staff safe rooms and 1 community safe room
- Historic features including the Rose Garden and Rock in a memorial courtyard, brick eagle, and more
- 2,500-seat gymnasium and 2 auxiliary gyms
- Indoor running track
- Finishes and materials that decrease ongoing maintenance costs, and energy efficiencies such as hydronic HVAC system, LED lighting, and window placement for increased natural light
- Expanded athletic complex that includes tennis courts and practice/competition fields for football, band, soccer, baseball, and softball—fields feature synthetic turf for reduced ongoing maintenance costs and lighting to allow for evening practices and games
- Performing Arts Center that includes a 1,250-seat auditorium, black box theater with indoor/outdoor seating for a variety of events, art gallery for showcasing student art, and choir, band, and orchestra rehearsal halls with sound isolating practice rooms
- Outdoor courtyards designed to accommodate specialized learning activities and support adjacent classroom halls
- Indoor and outdoor social spaces that foster student engagement

